

ALX Series

Grade 2 Modular, Cylindrical Locks

OVERVIEW

The Schlage® ALX Series is a Grade 2 lock unlike any other. Designed to exceed expectations, it features a single, patented chassis design that supports most functions and all cylinder applications. As a modular lock, ALX Series enables in-field function set up or exchange and a field-selectable Vandlgard® feature on all locking functions. Exceptional durability comes from a stainless steel latch bolt, deep-drawn spindles with 5 points of lever engagement and Grade 1 compression springs that prevent droop and wobble. Perfectly suited to the ND Grade 1 Series, ALX also allows you to seamlessly suite between the two to gain Grade 1 strength, security and functionality when and where you need it.

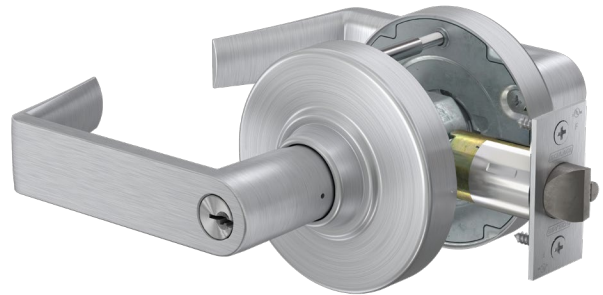

FINISHES



605
Bright Brass

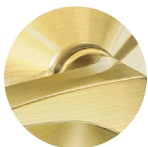

606
Satin Brass



612
Satin Bronze



613
Oil Rubbed
Bronze

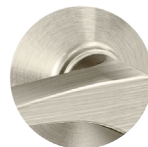

619
Satin Nickel



622
Matte Black



625
Bright Chrome

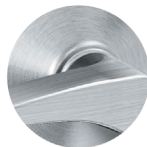

626
Satin Chrome

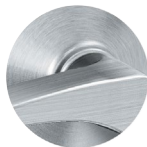

626AM
Satin Chrome
Antimicrobial

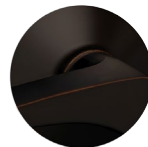

643e¹
Aged Bronze

1. e = an equivalent finish to the BHMA standard

LEVER STYLES



ATH (Athens)
8AT - Milled tactile warning



BRK (Boardwalk)
8BK - Knurled tactile warning

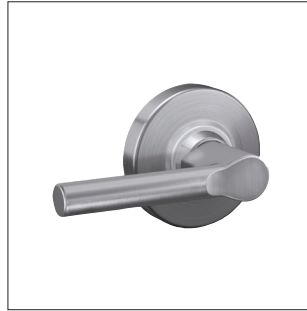

BRW (Broadway)
8BY - Knurled tactile warning

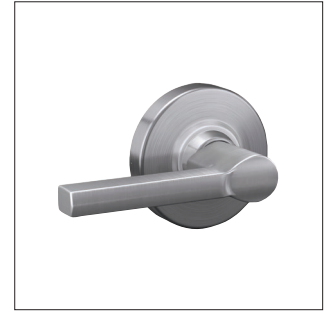

LAT (Latitude)
8LT - Milled tactile warning



LON (Longitude)
8LN - Milled tactile warning

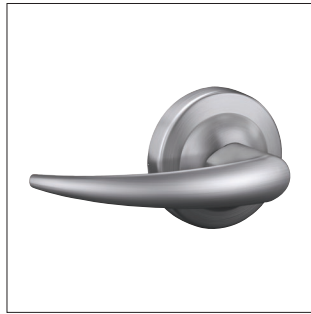

OME (Omega)



RHO (Rhodes)¹
8RO - Milled tactile warning¹



SAT (Saturn)



SPA (Sparta)
8SP - Milled tactile warning



TLR (Tubular)
8TR - Knurled tactile warning

Dimensions

Lever	Width	Projection
ATH (Athens)	4.56"	3.31"
BRK (Boardwalk)	4.94"	3.06"
BRW (Broadway)	4.50"	3.06"
LAT (Latitude)	4.50"	3.13"
LON (Longitude)	4.94"	3.13"
OME (Omega)	5.06"	3.31"
RHO (Rhodes)	4.56"	2.94"
SAT (Saturn)	4.43"	2.94"
SPA (Sparta)	4.94"	3.50"
TLR (Tubular)	4.94"	3.00"

Rose	Diameter
Standard	3.44"

¹ Return to door meets 1/2" requirement for Boardwalk (BRK), Longitude (LON), Omega (OME), Rhodes (RHO), Sparta (SPA) and Tubular (TLR) levers

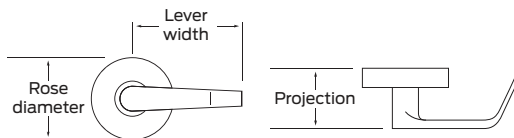

1. Optional break-away feature available on Rhodes levers for most locking functions. This allows the handheld part of the lever to break away from the shank when extreme torque is applied protecting the spring cage and locking mechanism from exterior access to help prevent unauthorized break-in.

MECHANICAL LOCK FUNCTIONS

Legend

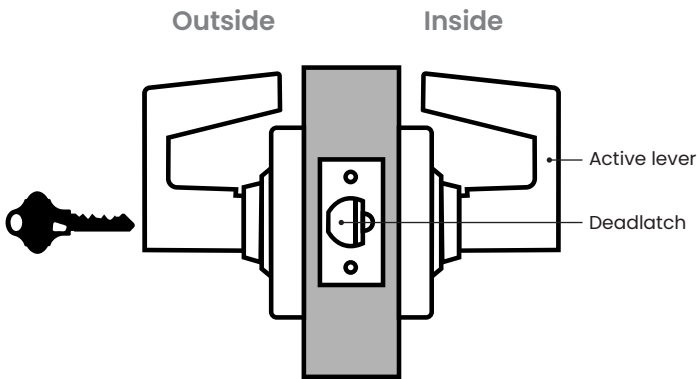

Key

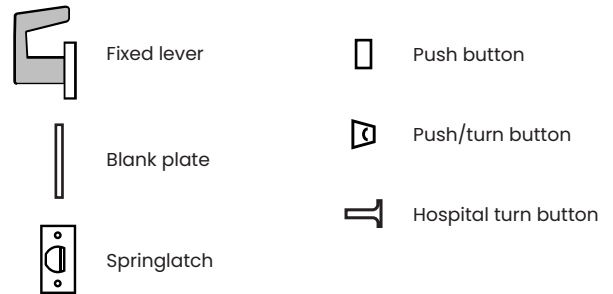

Product Identification Guide

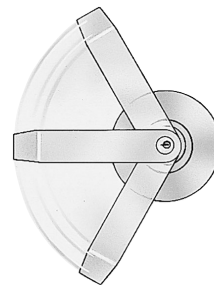
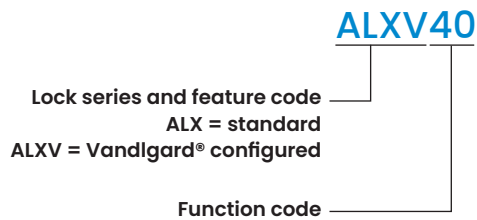

Vandlgard® Feature

All locking functions feature Vandlgard locked lever protection as a field configurable option. It allows the outside lever to rotate freely up and down when locked to limit the ability of vandals to apply excessive force to the chassis helping to prevent damage to internal components.

NON-KEYED FUNCTIONS

Schlage
ALX10

ANSI
F75

Schlage
ALX25

ANSI
-

Schlage
ALX40/ALXV40

ANSI
F76

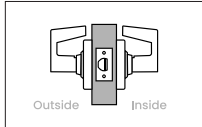

Passage latch

- Levers both sides; springlatch
- Latch retracted by lever from either side at all times
- Inside lever always free for immediate egress

Request to Exit (RX) available, kit sold separately.

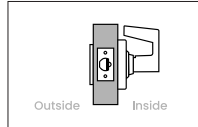

Exit lock with exterior blank plate

- Blank plate outside; lever inside; deadlatch
- Latch retracted by inside lever
- Inside lever always free for immediate egress

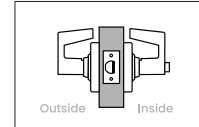

Bath/bedroom privacy lock

- Lever with emergency release recessed slot outside; push button in lever inside; springlatch
- In unlocked state latch is retracted by either lever
- Outside lever is made inoperative by pushing button on inside lever; Vandlgard® option allows outside lever, when locked, to rotate without engaging latch
- Rotating inside lever retracts latch and releases button unlocking outside lever; closing door also unlocks preventing lock-out
- Emergency unlock: an emergency key (sold separate) or small, flat screwdriver inserted in outside lever and turned releases button to unlock
- Inside lever always free for immediate egress

Request to Exit (RX) available, kit sold separately.

To order an emergency key use part number 35-270.

Schlage
ALX44/ALXV44

ANSI
-

Schlage
ALX170

ANSI
-

Schlage
ALX172

ANSI
-

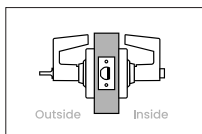

Hospital privacy lock

- Emergency turn in lever outside; push button in lever inside; springlatch
- In unlocked state latch is retracted by either lever
- Outside lever is made inoperative by pushing button on inside lever; Vandlgard® option allows outside lever to rotate freely when locked
- Rotating inside lever retracts latch and releases button unlocking outside lever; closing door also unlocks preventing lock-out
- Emergency unlock: rotating emergency turn in outside lever releases button to unlock
- Inside lever always free for immediate egress

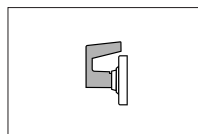

Single dummy trim

- Fixed lever one side only; no latch or chassis
- Used for door pull or matching inactive trim

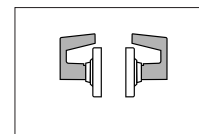

Double dummy trim

- Fixed levers—both sides; no latch or chassis
- Used for door pull or matching inactive trim

Note: Latch cover plates available. Order part number 47269199.

KEYED FUNCTIONS

Schlage
ALX50/ALXV50

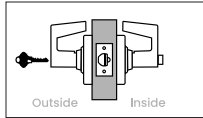

ANSI
F82
Entrance/office lock

- Lever with key cylinder outside; push button in lever inside; deadlatch
- In unlocked state latch is retracted by either lever
- Outside lever is made inoperative by pushing button on inside lever; key outside does not lock, Vandlgard® option allows outside lever to rotate freely when locked
- Key outside or rotating inside lever retracts latch and releases button unlocking outside lever
- Inside lever always free for immediate egress

Schlage
ALX53/ALXV53

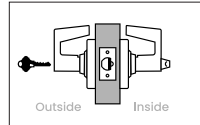

ANSI
F109
Entrance lock

- Lever with key cylinder outside; push/turn button in lever inside; deadlatch
- In unlocked state latch is retracted by either lever
- Outside lever is made inoperative by pushing button or pushing and turning button on inside lever; key outside does not lock, Vandlgard® option allows outside lever to rotate freely when locked
- **Pushed button unlocking:** key outside or rotating inside lever retracts latch and releases button unlocking outside lever
- **Pushed/turned button unlocking:** key outside or rotating inside lever retracts latch but does not unlock outside lever; rotate inside button to start position to allow button release and unlocking by key or by rotating inside lever
- Inside lever always free for immediate egress

Caution: Egress without fully releasing the push/turn button can result in lock-out situations.

Schlage
ALX70/ALXV70

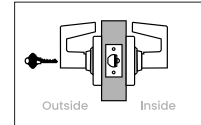

ANSI
F84
Classroom lock, exterior lockdown only

- Lever with key cylinder outside; lever inside; deadlatch
- In unlocked state latch is retracted by either lever
- Outside lever is locked or unlocked by key outside; Vandlgard® option allows outside lever to rotate freely when locked
- Inside lever always free for immediate egress

Schlage
ALX80/ALXV80

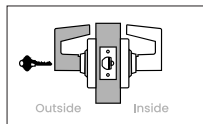

ANSI
F86
Storeroom lock

- Lever with key cylinder outside; lever inside; deadlatch
- Outside lever always fixed, latch retracted by inside lever; Vandlgard® option allows outside lever to rotate freely when locked
- Key in outside lever retracts latch only
- Inside lever always free for immediate egress

Request to Exit (RX) available, kit sold separately.



CYLINDERS

Conventional cylinder		ATH	BRK	BRW	LAT	LON	OME	RHO	SAT	SPA	TLR
P6	6-pin Conventional (standard)	•	•	•	•	•	•	•	•	•	•
P	6-pin Conventional (keyed 5)	•	•	•	•	•	•	•	•	•	•
Z	SL 7-pin Conventional (A2 pinning)	•	•	•	•	•	•	•	•	•	•
L	Less Conventional	•	•	•	•	•	•	•	•	•	•
L-CO ¹	Less cylinder, made to fit Corbin 2000-033	•						•		•	•
L-SA ¹	Less cylinder, made to fit Sargent C11-1, C10-1	•						•		•	•

Full size interchangeable core (FSIC)		ATH	BRK	BRW	LAT	LON	OME	RHO	SAT	SPA	TLR
R	6-pin FSIC (full size)	•	•	•	•	•	•	•		•	•
M	SL 7-pin FSIC (A2 pinning)	•	•	•	•	•	•	•		•	•
J	Less FSIC	•	•	•	•	•	•	•		•	•
J-CO6 ¹	Less cylinder, made to fit Corbin 6-pin	•						•		•	•
J-CO7 ¹	Less cylinder, made to fit Corbin 7-pin							•			
J-SA ¹	Less cylinder, made to fit Sargent 6300	•						•		•	•
T	Refundable FSIC construction core	•	•	•	•	•	•	•		•	•

Small format interchangeable core (SFIC)		ATH	BRK	BRW	LAT	LON	OME	RHO	SAT	SPA	TLR
G	7-pin SFIC (slide capping)	•	•	•	•	•	•	•		•	•
B	Less SFIC	•	•	•	•	•	•	•		•	•
BDC	Disposable SFIC construction core	•	•	•	•	•	•	•		•	•
H	Refundable SFIC construction core	•	•	•	•	•	•	•		•	•

1. Competitor cores not available on Classroom (70) functions.

SPECIFICATIONS

Chassis	
Material	Modular design of zinc and steel components plated for corrosion protection
Door thickness	Standard: 1-3/8" (35 mm) to 1-3/4" (44 mm)
Handing	Non-handed
Trim	
Levers	Standard: Pressure cast zinc, plated to match product finish specification in ten designs - Athens (ATH), Boardwalk (BRK), Broadway (BRW), Latitude (LAT), Longitude (LON), Omega (OME), Rhodes (RHO), Saturn (SAT), Sparta (SPA), and Tubular (TLR) Optional: Tactile feature available on most designs, specify 8AT, 8BK, 8BY, 8LT, 8LN, 8RO, 8SP, or 8TR
Roses	Wrought brass, plated to match product finish specification
Finishes	Nine available: 605, 606, 612, 613, 619, 622, 625, 626, 643E; optional antimicrobial coating is available on 626—order as 626AM
Latch	
Backset	Standard: 2-3/4" (70 mm) Optional: 2-3/8", 3-3/4", 5" (60, 95, 127 mm)
Faceplate	Standard: 1-1/8" x 2-1/4" (29 mm x 57 mm) square corners Optional: Multiple options with square or radius corners
Latch	Standard: 1/2" (13 mm) throw spring latch or deadlatch (Stainless Steel) with 7/8" housing diameter Optional: 3/4" (19 mm) throw anti-friction fire deadlatch
Strike	Standard: ANSI curved lip: 1-1/4" x 4-7/8" x 1-3/16" (32 mm x 124 mm x 30 mm) Optional: T Strike, ANSI strikes with alternative lip lengths, dust box options
Keying	
Formats	Standard: 6-pin Conventional cylinder with two patented keys Optional: FSIC, SFIC, and 7-pin SL cylinder formats plus less cylinder options made to fit non-Schlage cylinders from Corbin Russwin and Sargent
Keyways	Standard: 6-pin, patented Everest 29 S123 keyway Optional: Open, restricted, Primus®, master keying, and construction keying
Warranty	
	10 years mechanical
Certifications	
ANSI/BHMA	Certified A156.2-2022 Series 4000, Grade 2; exceeds standard for lever and spindle strength and durability
ICC	Complies with ICC A117.1 for Accessible and Usable Buildings and Facilities
UL/cUL	All locks listed for A label single fire door 4' x 8' or 4' x 10' 3-hour; pair doors 8' x 8' 3-hour; and 8' x 10' 90-minute; Letter F and UL symbol on latch front indicate listing
UL 437	Optional UL listed high-security cylinders available in Conventional format
CA Fire Code	All levers with a return to door of 1/2" (13 mm) or less comply (Boardwalk, Longitude, Omega, Rhodes, Saturn, Sparta, and Tubular)
FL Building Code	ASTM E330, E1886, E1996 and Miami Dade (TAS 201, 202, 203) requirements for hurricanes
Federal	Meets FF-H-106C Series 161
ADA compliant	All lever designs meet Americans with Disabilities Act requirements